

### LOCATION MAP

APPLICANT: Highfair Investments (BT) Inc.  
 FILES: SUB-2021-02 & ZBA-2021-06



**SUBJECT LANDS**

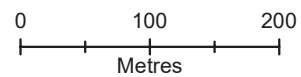
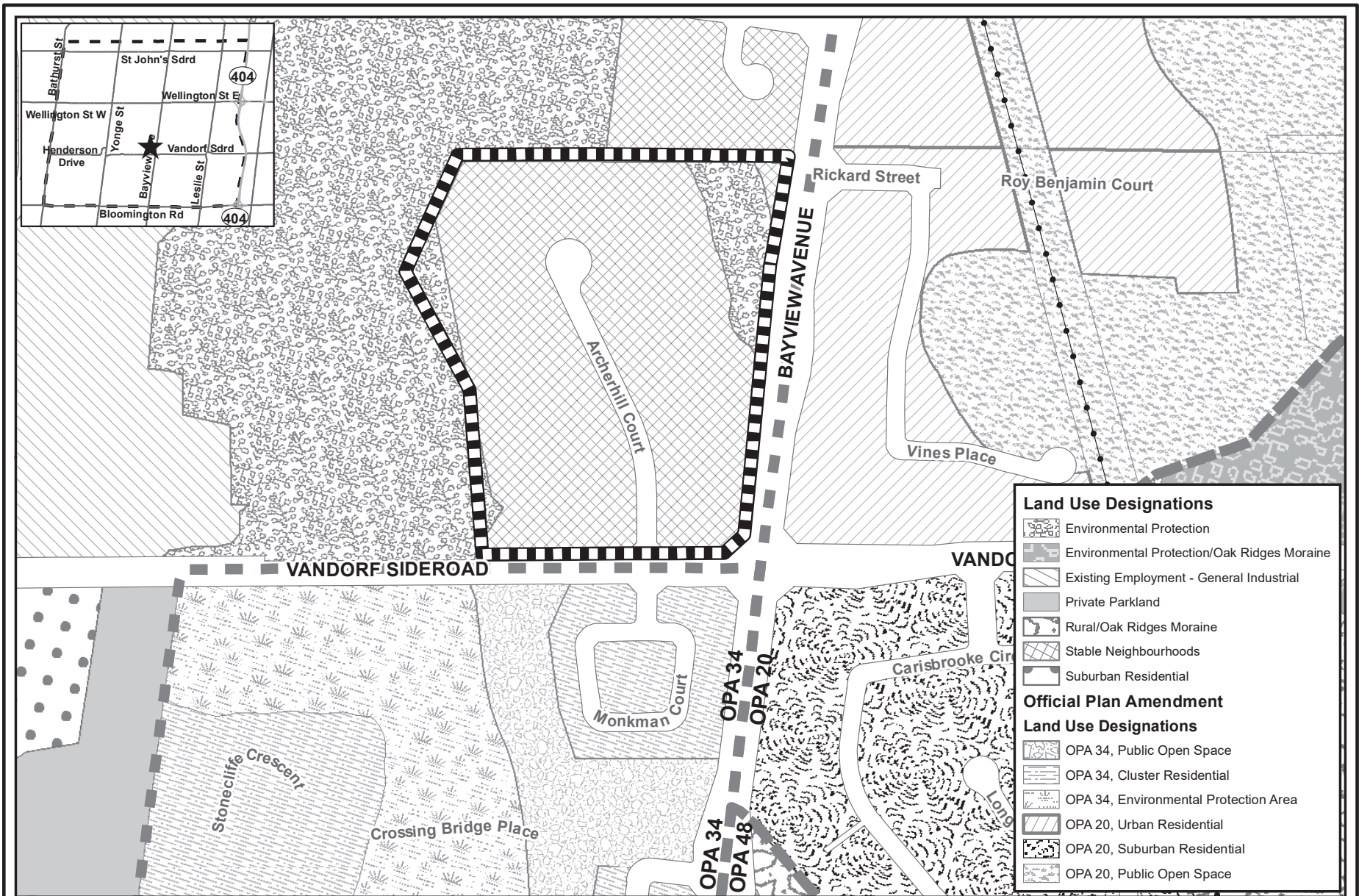

FIGURE 1

Map created by the Town of Aurora Planning and Building Services Department, 15/12/2022. Base data provided by York Region & the Town of Aurora. Air Photos taken Spring 2022, © First Base Solutions Inc., 2022 Orthophotography.



## EXISTING OFFICIAL PLAN DESIGNATION

APPLICANT: Highfair Investments (BT) Inc.

FILES: SUB-2021-02 & ZBA-2021-06

FIGURE 2



**SUBJECT LANDS**

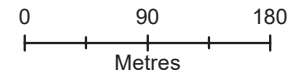

Map created by the Town of Aurora Planning and Building Services Department, 15/12/2022. Base data provided by York Region & the Town of Aurora.

Document Path: J:\data\data\Planning Maps\Highfair Investments Inc (ZBA-2021-06, SUB-2021-02; Archerhill)\Report\_Dec\_2022\Figure\_2\_Existing\_Official\_Plan\_Designation.mxd

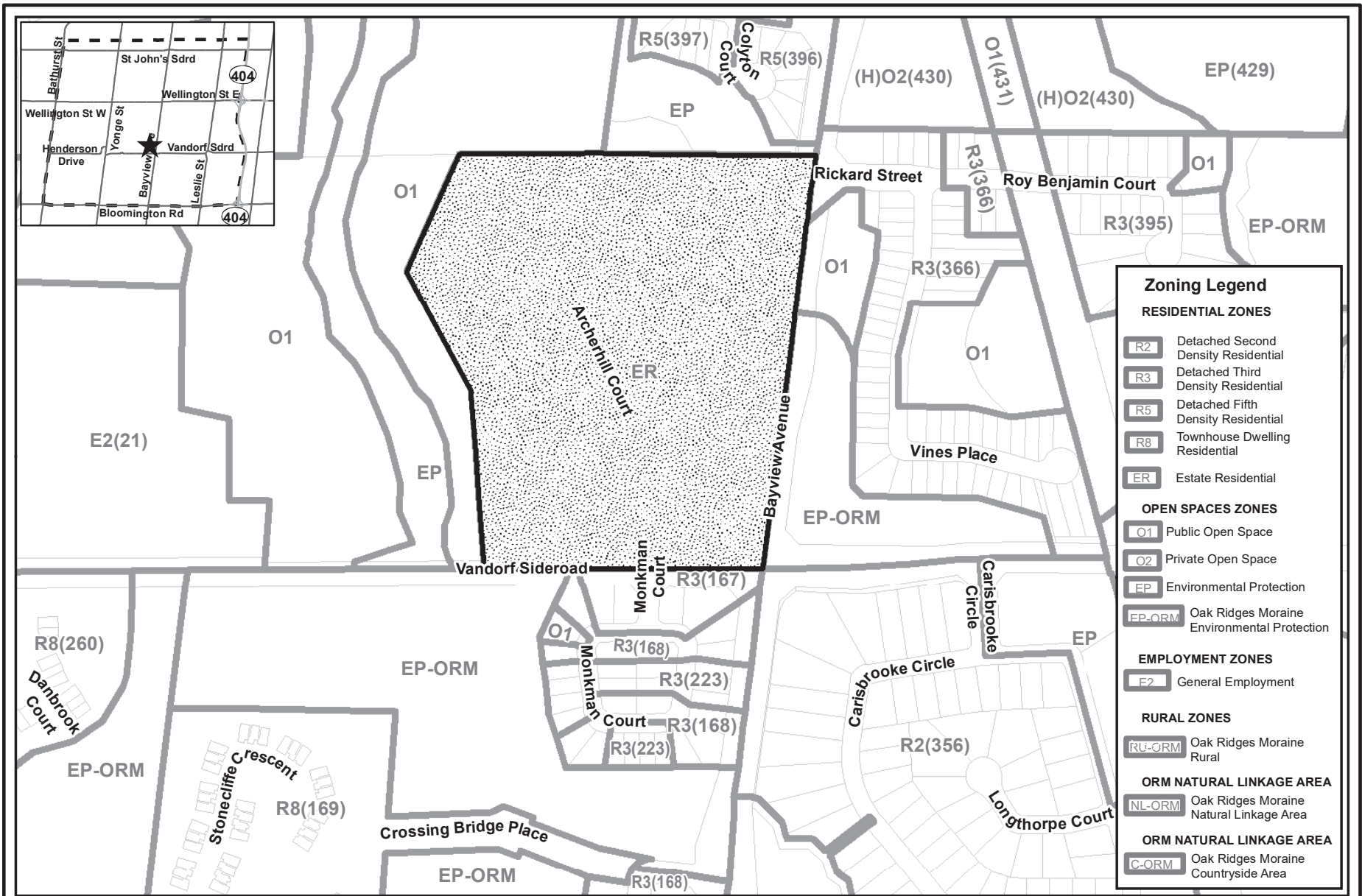

Zoning Legend	
RESIDENTIAL ZONES	
R2	Detached Second Density Residential
R3	Detached Third Density Residential
R5	Detached Fifth Density Residential
R8	Townhouse Dwelling Residential
ER	Estate Residential
OPEN SPACES ZONES	
O1	Public Open Space
O2	Private Open Space
EP	Environmental Protection
EP-ORM	Oak Ridges Moraine Environmental Protection
EMPLOYMENT ZONES	
E2	General Employment
RURAL ZONES	
RU-ORM	Oak Ridges Moraine Rural
ORM NATURAL LINKAGE AREA	
NL-ORM	Oak Ridges Moraine Natural Linkage Area
ORM NATURAL LINKAGE AREA	
C-ORM	Oak Ridges Moraine Countryside Area

## EXISTING ZONING BY-LAW

APPLICANT: Highfair Investments (BT) Inc.  
 FILES: SUB-2021-02 & ZBA-2021-06  
 FIGURE 3

 SUBJECT LANDS

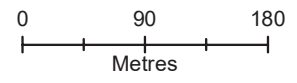

Map created by the Town of Aurora Planning and Building Services Department, 15/12/2022. Base data provided by York Region & the Town of Aurora.

Document Path: J:\data\data\Planning Maps\Highfair Investments Inc (ZBA-2021-06, SUB-2021-02, Archerhill)\Report\_Dec\_2022\Figure\_3\_Existing\_Zoning\_By-law.mxd

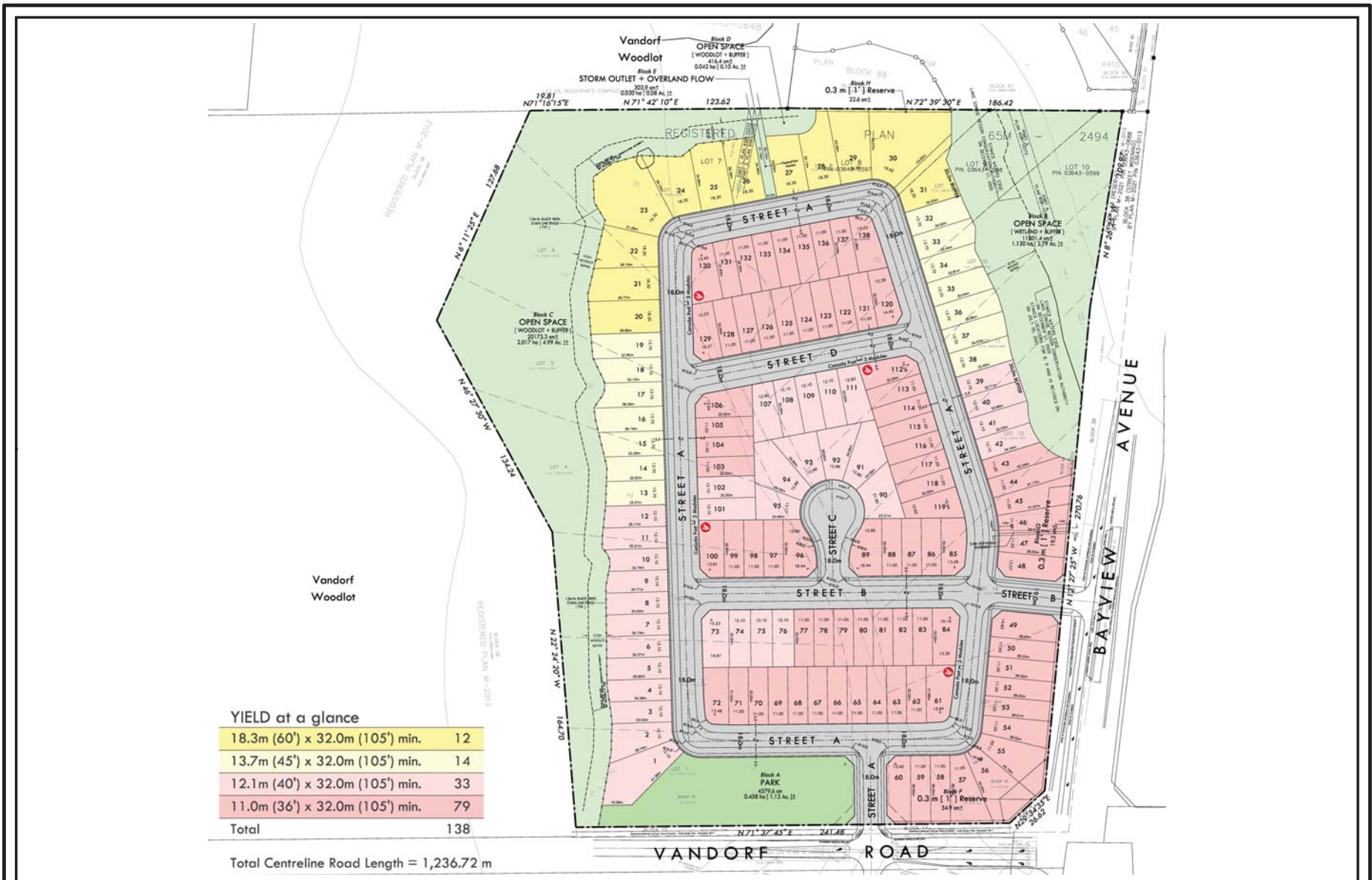

## PROPOSED DRAFT PLAN OF SUBDIVISION

APPLICANT: Highfair Investments (BT) Inc  
 FILES: SUB-2021-02 & ZBA-2021-06

FIGURE 4



Map created by the Town of Aurora Planning and Building Services Department, 15/12/2022. Data provided by miCAD Inc.