

LEGEND

- STORM CONNECTION
- SANITARY CONNECTION
- W- WATER CONNECTION
- H- HYDRO CONNECTION
- ▨ DOUBLE CATCH BASIN
- ▨ CATCH BASIN
- STREET LIGHT
- HYDRANT
- ▣ TRANSFORMER
- ▣ CABLE TV PEDESTAL
- ▣ BELL PEDESTAL
- △ ENTRANCE DOOR LOCATION
- × GARAGE DOOR LOCATION
- MAIL COMMUNITY MAILBOX
- ★ ENGINEERED FILL LOT
- VALVE AND CHAMBER
- SANITARY MANHOLE
- STORM MANHOLE
- ▣ AIR-CONDITIONING UNIT
- ▣ PROPOSED GRADE
- ▣ EXISTING GRADE
- ▣ PROPOSED SWALE GRADE
- ▣ DOWNSPOUT LOCATION
- ▣ TELECOM. JUNCTION BOX
- ▣ PROPOSED BERM
- ▣ SWALE DIRECTION
- ▣ HYDRO METER
- ▣ GAS METER
- FFL FINISHED FLOOR ELEVATION
- TFW TOP OF FOUNDATION WALL
- FBS FIN. BASEMENT FLOOR SLAB
- USF UNDERSIDE FOOTING ELEVATION
- BH 1 BOREHOLE LOCATION
- A A' SLOPE SECTION
- G GARBAGE BIN
- R RECYCLING BIN

METRIC
DISTANCES SHOWN ON THIS PLAN ARE
IN METRES AND CAN BE CONVERTED
TO FEET BY DIVIDING BY 0.3048.

COMPLIANCE PACKAGE "A1"

The Architectural Technologist is not responsible for the accuracy of survey, structural, mechanical, electrical, etc. engineering information shown on the drawing. Refer to the appropriate engineering drawings before proceeding with work.

Contractor shall check all dimensions on the work and report any discrepancy to the Architectural Technologist before proceeding. Construction must conform to all applicable Codes and Requirement of Authorities having Jurisdiction.

All drawings, specifications and related documents are the copyright property of Peter Del Grosso O/A 2493572 Ontario Inc. and must be returned upon request. Reproduction of drawings, specifications and related documents in part or whole is forbidden without the permission of Peter Del Grosso.

This drawing is not to be scaled.

This drawing is not to be used for construction unless signed by the Architectural Technologist.

8.		
7.		
6.		
5.		
4.		
3.	OCT. 1/24	REDUCED FRONT YARD SETBACK
2.	SEPT. 16/24	REV. BARRIER-FREE PARKING
1.	DEC. 9/23	ISSUED FOR REVIEW
NO:	DATE:	REVISION:

SITE STATS

LOT AREA: 399.22m²
BUILDING AREA: 92.53m² (23.2%)
PARKING PROVIDED: 7 (INCLUDES 1 B.F.)

TYLER STREET

TEMPERANCE STREET

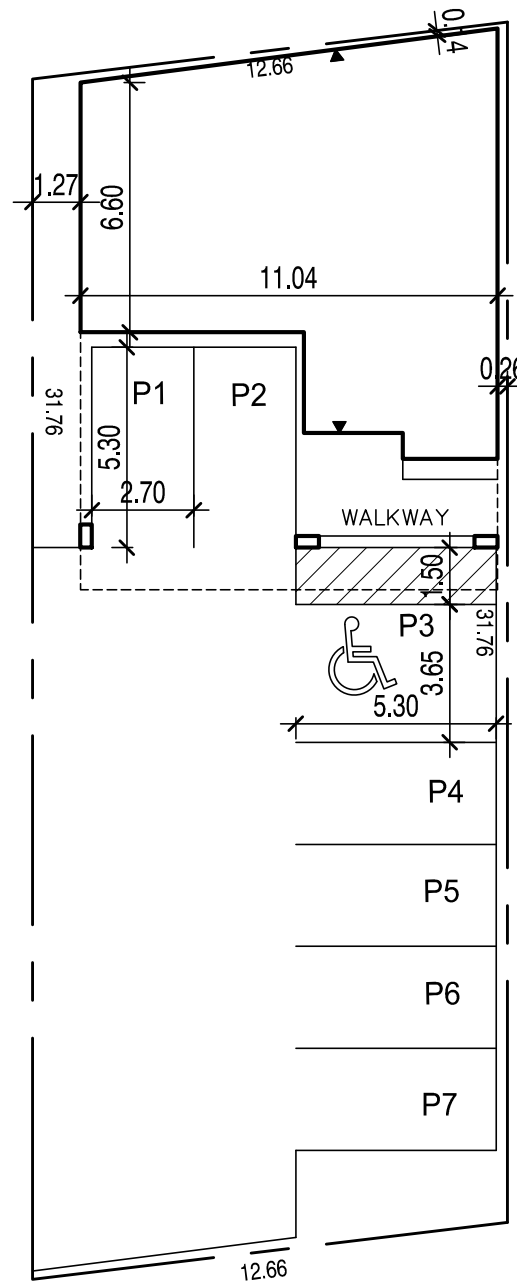

3.65

ITEM	ONTARIO BUILDING CODE DATA MATRIX	OBV REFERENCE
1	PROJECT DESCRIPTION: <input type="checkbox"/> NEW <input checked="" type="checkbox"/> PART 11 <input type="checkbox"/> ADDITION <input type="checkbox"/> ALTERATION <input type="checkbox"/> CHANGE OF USE	<input type="checkbox"/> PART 3 <input type="checkbox"/> PART 9 A1.1.2.
2	MAJOR OCCUPANCY(S) GROUP C	3.1.2.1.(1)
3	BUILDING AREA (m ²) 110.82m ²	A1.4.1.2.
4	GROSS AREA (m ²) 494.84m ²	A1.4.1.2.
5	NUMBER OF STOREYS ABOVE GRADE 5 BELOW GRADE 1	A1.4.1.2./3.2.1.1.
6	HEIGHT OF BUILDING (m) 20.17m	A1.4.1.2./3.2.1.1.
7	NUMBER OF STREETS/ACCESS ROUTES 2	3.2.2.10./3.2.5.
8	BUILDING CLASSIFICATION PART 3	3.1.2.1.(1)
9	SPRINKLER SYSTEM PROPOSED <input type="checkbox"/> ENTIRE BUILDING <input type="checkbox"/> BASEMENT ONLY <input type="checkbox"/> IN LIEU OF ROOF RATING <input checked="" type="checkbox"/> NOT REQUIRED	3.2.2.53.
10	STANDPIPE REQUIRED <input type="checkbox"/> YES <input checked="" type="checkbox"/> NO	
11	FIRE ALARM REQUIRED <input checked="" type="checkbox"/> YES <input type="checkbox"/> NO	
12	WATER SERVICE/ SUPPLY IS ADEQUATE <input checked="" type="checkbox"/> YES <input type="checkbox"/> NO	
13	HIGH BUILDING <input type="checkbox"/> YES <input checked="" type="checkbox"/> NO	
14	PERMITTED CONSTRUCTION <input type="checkbox"/> COMBUSTIBLE <input type="checkbox"/> NON-COMBUSTIBLE <input checked="" type="checkbox"/> BOTH ACTUAL CONSTRUCTION <input type="checkbox"/> COMBUSTIBLE <input type="checkbox"/> NON-COMBUSTIBLE <input checked="" type="checkbox"/> BOTH	3.2.2.53.
15	MEZZANINE(S) AREA m ² N/A	A1.4.1.2.
16	OCCUPANT LOAD BASED ON <input type="checkbox"/> m ² /PERSON <input type="checkbox"/> DESIGN OF BUILDING BASEMENT: OCCUPANCY LOAD PERSONS 1st FLOOR OCCUPANCY C LOAD 4 PERSONS 2nd/3rd FLOOR OCCUPANCY C LOAD 4 PERSONS 4th FLOOR OCCUPANCY C LOAD 4 PERSONS	3.1.17.
17	BARRIER-FREE DESIGN <input checked="" type="checkbox"/> YES <input type="checkbox"/> NO	11.3.3.2.(2)
18	HAZARDOUS SUBSTANCES <input type="checkbox"/> YES <input checked="" type="checkbox"/> NO	3.1.17.
19	REQUIRED FIRE RESISTANCE RATING (FRR) HORIZONTAL ASSEMBLIES LISTED DESIGN NO. OR DESCRIPTION (SG-2) FLOORS 45 HOURS ROOFS 45 HOURS MEZZANINE 0 HOURS FRR OF SUPPORTING MEMBERS FLOORS 45 HOURS ROOFS 45 HOURS MEZZANINE 0 HOURS	3.2.2.53.
20	SPATIAL SEPARATION-CONSTRUCTION OF EXTERIOR WALLS WALL AREA OF EBF (m ²) L.D. (m) L.H. OR H.L. PERMITTED MAX.% OF OPENINGS PROPOSED % OF OPENINGS FRR (HOURS) LISTED DESIGN OR DESCRIPTION COMB. CONST. COMB. CONSTR./NON-COMB. CLADDING NON-COMB. CONSTR.	9.10.14

DRAWING TITLE:

SITE PLAN

P DEL DESIGN
4370 Steeles Avenue West,
Suite 203
Woodbridge, Ontario L4L 4Y4
T: 416 453 9985
e-mail: peterd@pdeldesign.ca
www.pdeldesign.ca

The undersigned has reviewed and takes responsibility for this design, and has the qualifications and meets the requirements set out in the Ontario Building Code to design the work shown on the attached documents

QUALIFICATION INFORMATION

Required unless design is exempt under Division C, Subsection 3.2.5 of the Building Code

PETER DEL GROSSO 20567

REGISTRATION INFORMATION

Required unless design is exempt under Division C, Subsection 3.2.4 of the Building Code

PETER DEL GROSSO 27288

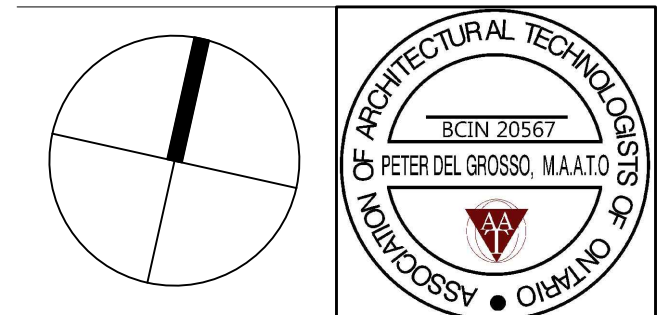

PROJECT:
PROPOSED 5 STOREY BUILDING

15 TYLER STREET
AURORA, ONTARIO

AREA: DATE: JULY 24/24
SCALE: 1:200 DRAWN BY: PDG

DRAWING No.:

SP-01

PROJECT No.: 00-00