

All Drawings, Specifications, and Related Documents are the Copyright of the Architect. The Architect retains all rights to control all uses of these documents for the intended issuance/use as identified below. Reproduction of these Documents, without permission from the Architect, is strictly prohibited. The Authorities Having Jurisdiction are permitted to use, distribute, and reproduce these drawings for the intended issuance as noted and dated below, however the extended permission to the Authorities Having Jurisdiction in no way debases or limits the Copyright of the Architect, or control of use of these documents by the Architect.

Do not scale the drawings.
This Drawing is Not To Be Used For Construction Until Signed By The Architect. August 07, 2024



No.: Revision: Date:

2.	ZBA/SPA Submission	August 07, 2024
1.	ZBA/SPA Submission	November 29, 2023
No.:	Issued For:	Date:

Drawing Title:

200 Wellington Site Plan & 7 Lacey Court Site Plan

Client:
200 WELLINGTON HOLDING CORP.

Project:
PROPOSED RESIDENTIAL DEVELOPMENT

7 LACEY COURT, AURORA, ONTARIO
Scale:
1 : 300
Drawn by:
L.A.
Checked by:
S.K.
Project No.:
23-006
Date:
August 07, 2024
Drawing No.:

200 Wellington Street West

OLT Approved in Principle (OPA-2021-06; ZBA-2021-08; SP-2022-06)

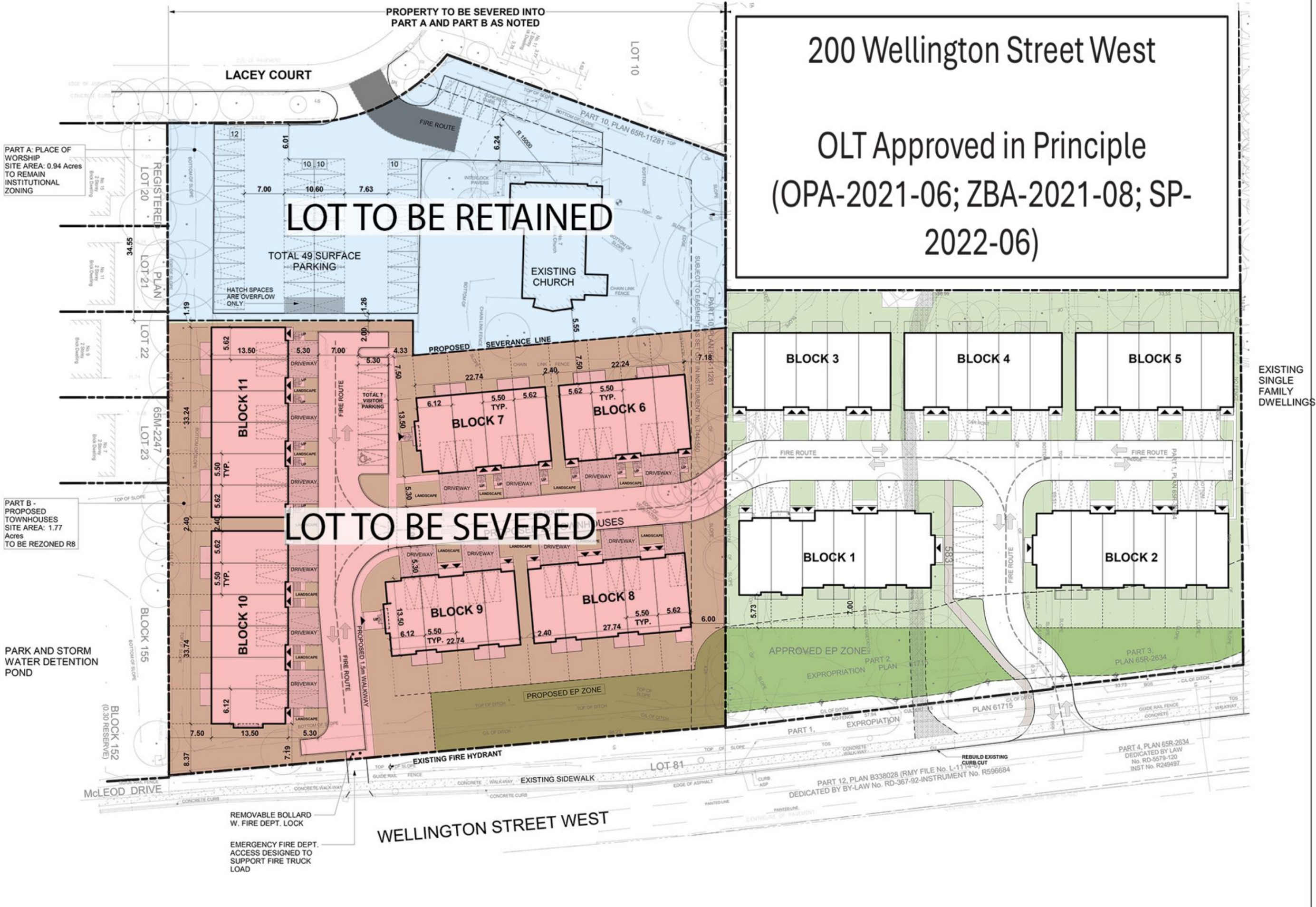

PART A: PLACE OF WORSHIP
SITE AREA: 0.94 Acres
TO REMAIN INSTITUTIONAL ZONING

PART B - PROPOSED TOWNHOUSES
SITE AREA: 1.77 Acres
TO BE ZONED R8

PARK AND STORM WATER DETENTION POND

REMOVABLE BOLLARD W. FIRE DEPT. LOCK
EMERGENCY FIRE DEPT. ACCESS DESIGNED TO SUPPORT FIRE TRUCK LOAD

EXISTING SINGLE FAMILY DWELLINGS

File Path: C:\Users\j\Documents\23-006-P11-Wellington Street @ Church_RVT25_current_Labels\SP\A1.2.dwg