



Happy Woodland Pet Cemetery

Site Alteration Permit

Presentation to the Heritage Advisory Committee

Monday, February 3, 2025



Agenda

- 1) Site Overview
- 2) Items Requiring Alteration
 - a) Pathways
 - b) Monument Relocation and Restoration
 - c) Problematic Monuments
 - d) Landscape Maintenance and Design Enhancements
- 3) Discussion

An aerial photograph of a snowy forest. The ground is covered in a layer of snow, and the trees are mostly bare, with some evergreens visible. Overlaid on the image is a site plan or map, showing various rectangular and circular structures, paths, and boundaries. The plan is drawn in a light color, possibly white or light grey, and is centered on the image. The text "Site Overview" is written in a large, white, sans-serif font across the middle of the image, with a white horizontal line underneath it.

Site Overview

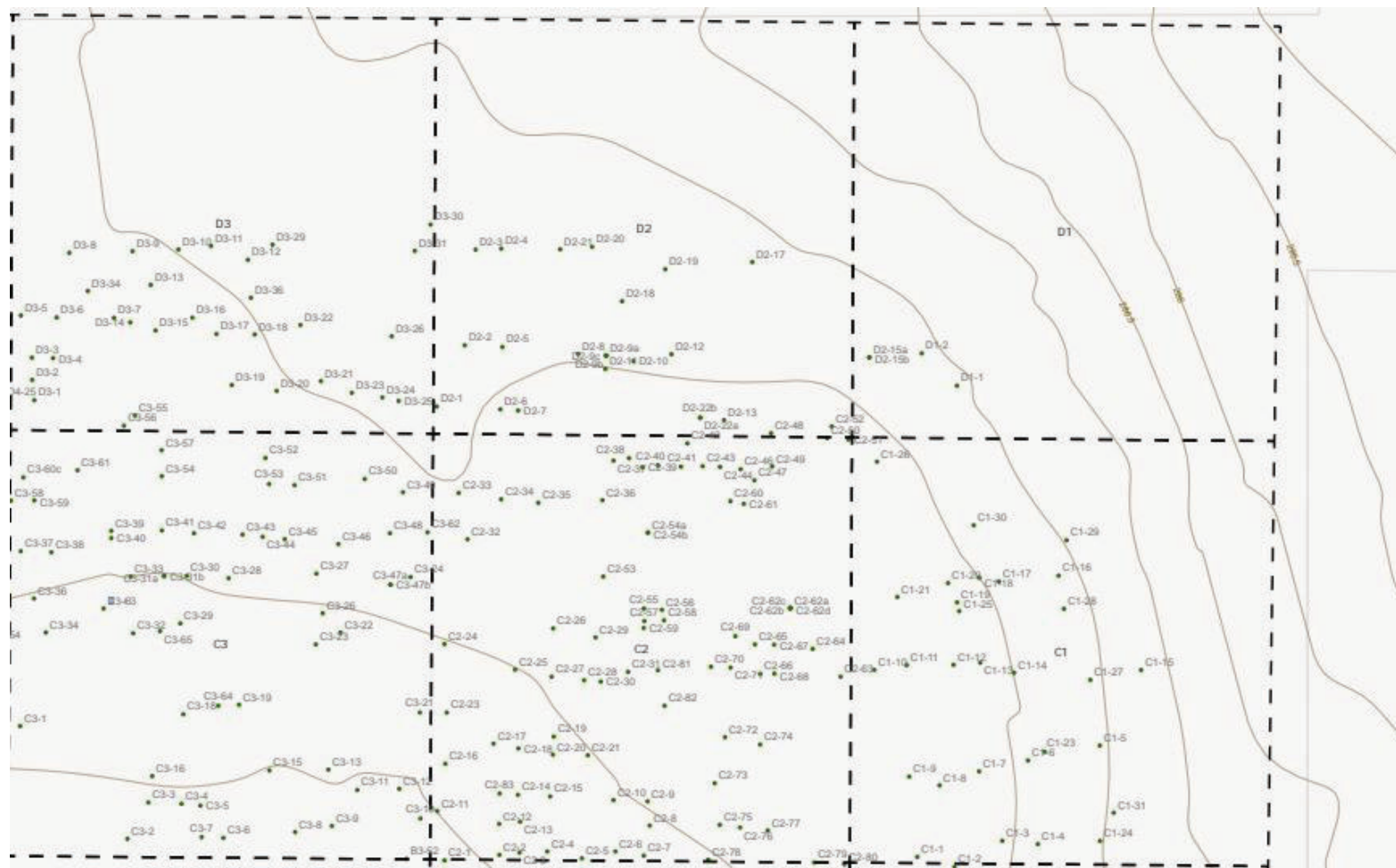



Pathways



A photograph of a forest with pink survey flags and a pink ribbon marking a site for relocation and restoration. The text "Relocation and Restoration" is overlaid in white, centered on the image. A white horizontal line is positioned below the text.

Relocation and Restoration





Problematic Monuments





Landscape Maintenance & Design Enhancements



A dark, atmospheric photograph of a forest. The scene is dimly lit, with a person walking away from the camera on a path. The trees are mostly bare, suggesting a winter or late autumn setting. The overall mood is somber and contemplative. The word "Discussion" is centered in the middle of the image in a white, sans-serif font, with a thin white horizontal line underneath it.

Discussion