

LOCATION MAP

APPLICANT: 2697331 Ontario Inc
FILES: OPA-2022-02 & ZBA-2022-02

 SUBJECT LANDS

0 100 200
Metres



FIGURE 1

Map created by the Town of Aurora Planning and Building Services Department, 03/06/2022. Base data provided by York Region & the Town of Aurora. Air Photos taken Spring 2021, © First Base Solutions Inc., 2021 Orthophotography.

Document Path: J:\data\data\Planning Maps\1289 Wellington Street East (Leslie-Wellington Developments Inc) (SUB-2016-01, OPA-2016-01 & ZBA-2016-03)\Report_Maps_June_2022\Figure_1_Location_Plan.mxd

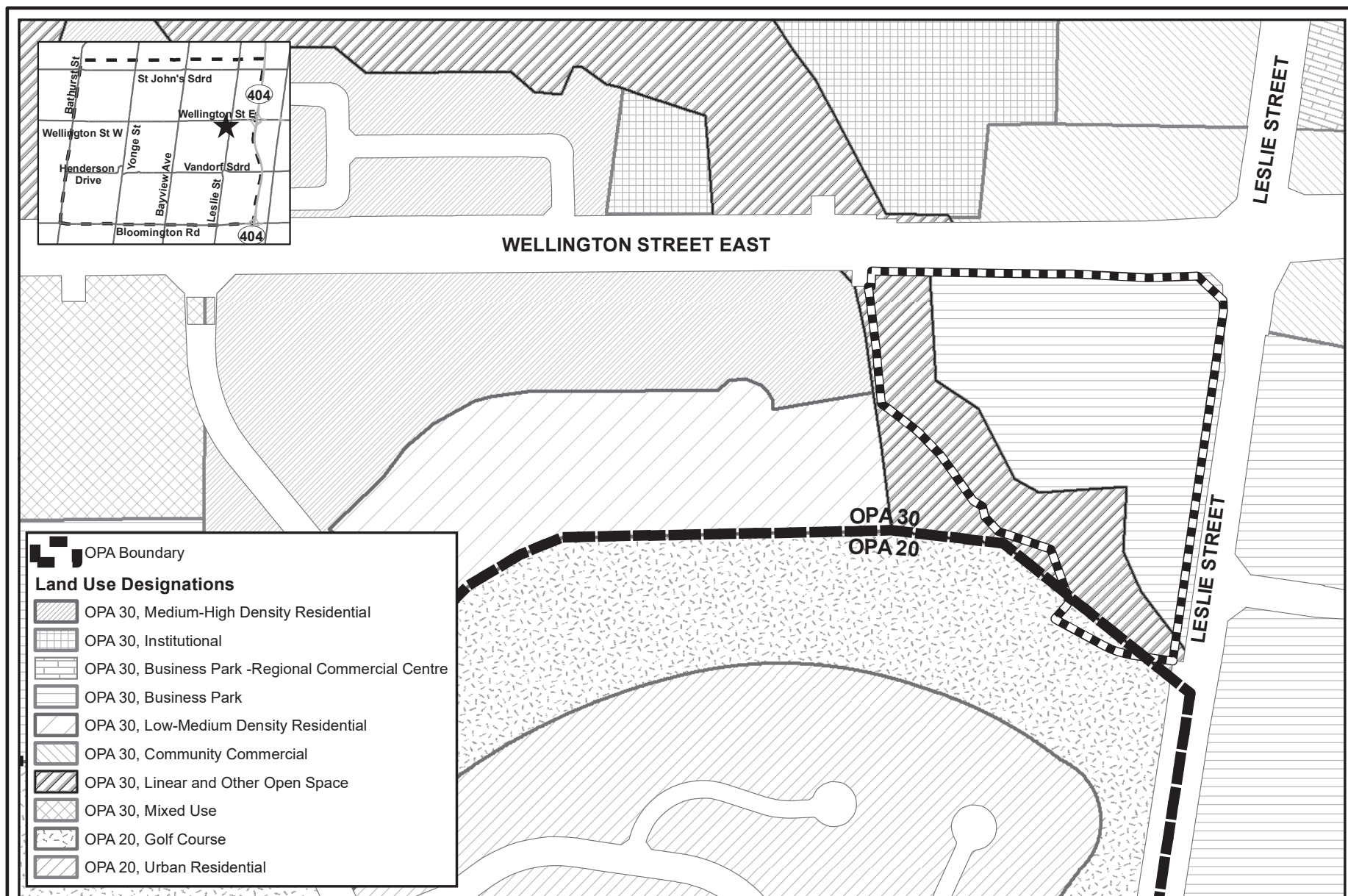

SUBJECT LANDS

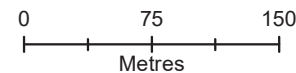

Map created by the Town of Aurora Planning and Building Services Department, 12/05/2022. Base data provided by York Region & the Town of Aurora.

Document Path: J:\data\data\Planning Maps\1289 Wellington Street East (Leslie-Wellington Developments Inc) (SUB-2016-01, OPA-2016-01 & ZBA-2016-03)\Report_Maps_June_2022\Figure_2_Existing_Official_Plan_Designation2.mxd

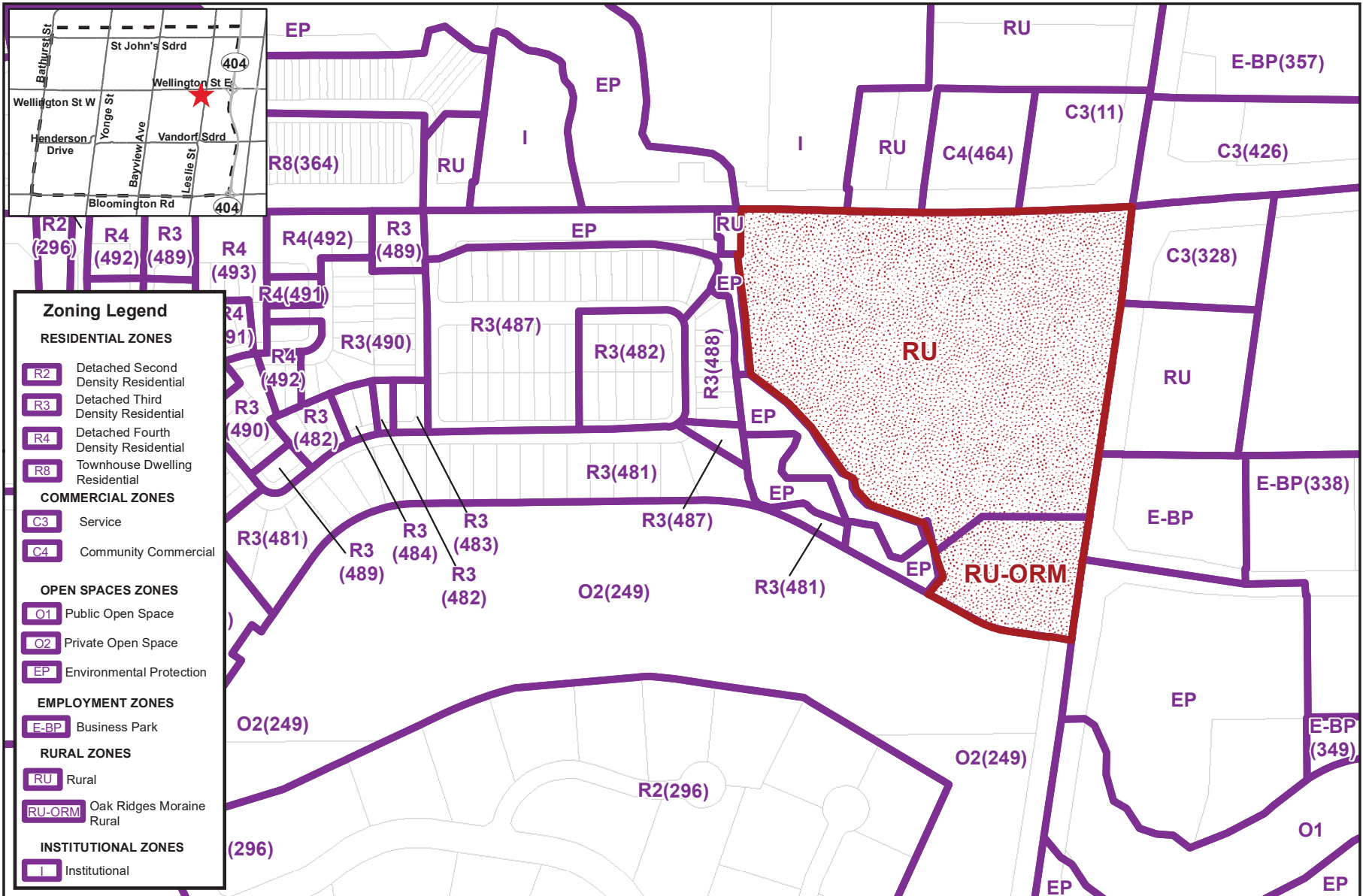

EXISTING ZONING BY-LAW

APPLICANT: 2697331 Ontario Inc
 FILES: OPA-2022-02 & ZBA-2022-02
 FIGURE 3

 **SUBJECT LANDS**

0 75 150
 Metres



Map created by the Town of Aurora Planning and Building Services Department, 07/06/2022. Base data provided by York Region & the Town of Aurora.

Document Path: J:\data\data\Planning Maps\1289 Wellington Street East (Leslie-Wellington Developments Inc) (SUB-2016-01, OPA-2016-01 & ZBA-2016-03)\Report_Maps_June_2022\Figure_3_Existing_Zoning_By-law.mxd

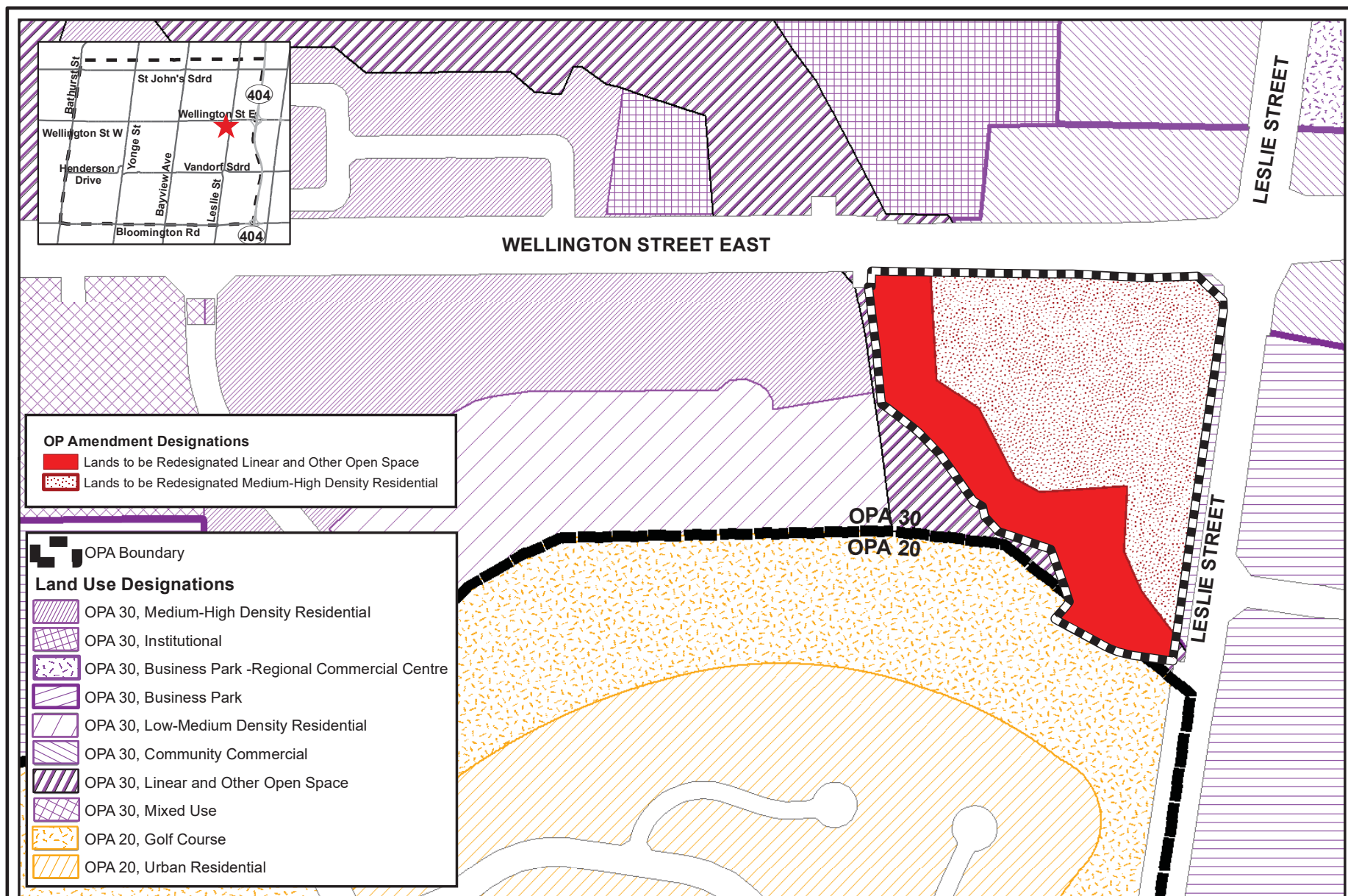

PROPOSED OFFICIAL PLAN DESIGNATION

APPLICANT: 2697331 Ontario Inc
 FILES: OPA-2022-02 & ZBA-2022-02
 FIGURE 4

 **SUBJECT LANDS**

0 75 150
 Metres



Map created by the Town of Aurora Planning and Building Services Department, 07/06/2022. Base data provided by York Region & the Town of Aurora.

Document Path: J:\data\data\Planning Maps\1289 Wellington Street East (Leslie-Wellington Developments Inc) (SUB-2016-01, OPA-2016-01 & ZBA-2016-03)\Report_Maps_June_2022\Figure_4_Proposed_Official_Plan_Designation.mxd



PROPOSED ZONING BY-LAW AMENDMENT DESIGNATION

APPLICANT: 2697331 Ontario Inc
FILES: OPA-2022-02 & ZBA-2022-02

FIGURE 5



Map created by the Town of Aurora Planning and Building Services Department, 07/06/2022. Base data provided by York Region & the Town of Aurora.

Document Path: J:\data\data\Planning Maps\1289 Wellington Street East (Leslie-Wellington Developments Inc) (SUB-2016-01, OPA-2016-01 & ZBA-2016-03)\Report_Maps_June_2022\Figure_5_Proposed_Zoning_ByLaw_Amendment_Designation.mxd



SITE PLAN

APPLICANT: 2697331 Ontario Inc
FILES: OPA-2022-02 & ZBA-2022-02

FIGURE 6



Map created by the Town of Aurora Planning and Building Services Department, 07/06/2022. Base data provided by York Region & the Town of Aurora.

Document Path: J:\data\data\Planning Maps\1289 Wellington Street East (Leslie-Wellington Developments Inc) (SUB-2016-01, OPA-2016-01 & ZBA-2016-03)\Report_Maps_June_2022\Figure_6_Site_Plan.mxd



RENDERINGS

APPLICANT: 2697331 Ontario Inc
FILES: OPA-2022-02 & ZBA-2022-02

FIGURE 7



Map created by the Town of Aurora Planning and Building Services Department, 07/06/2022. Base data provided by York Region & the Town of Aurora.

Document Path: J:\data\data\Planning Maps\1289 Wellington Street East (Leslie-Wellington Developments Inc) (SUB-2016-01, OPA-2016-01 & ZBA-2016-03)\Report_Maps_June_2022\Figure_7_Renderings.mxd



RENDERINGS

APPLICANT: 2697331 Ontario Inc
FILES: OPA-2022-02 & ZBA-2022-02

FIGURE 8



Map created by the Town of Aurora Planning and Building Services Department, 07/06/2022. Base data provided by York Region & the Town of Aurora.

Document Path: J:\data\data\Planning Maps\1289 Wellington Street East (Leslie-Wellington Developments Inc) (SUB-2016-01, OPA-2016-01 & ZBA-2016-03)\Report_Maps_June_2022\Figure_10_Renderings.mxd



RENDERINGS

APPLICANT: 2697331 Ontario Inc
FILES: OPA-2022-02 & ZBA-2022-02

FIGURE 9



Map created by the Town of Aurora Planning and Building Services Department, 07/06/2022. Base data provided by York Region & the Town of Aurora.

Document Path: J:\data\data\Planning Maps\1289 Wellington Street East (Leslie-Wellington Developments Inc) (SUB-2016-01, OPA-2016-01 & ZBA-2016-03)\Report_Maps_June_2022\Figure_11_Renderings.mxd



RENDERINGS

APPLICANT: 2697331 Ontario Inc
FILES: OPA-2022-02 & ZBA-2022-02

FIGURE 10



Map created by the Town of Aurora Planning and Building Services Department, 07/06/2022. Base data provided by York Region & the Town of Aurora.

Document Path: J:\data\data\Planning Maps\1289 Wellington Street East (Leslie-Wellington Developments Inc) (SUB-2016-01, OPA-2016-01 & ZBA-2016-03)\Report_Maps_June_2022\Figure_13_Renderings.mxd